

## CEVI VARJENE PO :

- TIG (EN 10217-7 / A554) D3 T3
- VF (EN 10296-2) D2 T3

Po naročilu lahko dobavimo določene dimenzije brušenih, poliranih ali cevi za prehrabno industrijo po DIN 11850/10357

Dolžina cevi: Cca. 6 m

Toleranca: ISO 1127

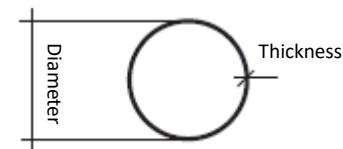
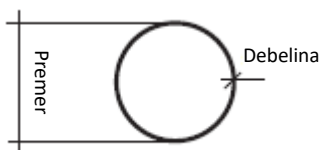

## WELDED TUBES PROCEDURE

- TIG (EN 10217-7 / A554) D3 T3
- HF (EN 10296-2) D2 T3

On request we can supply some dimensions of polished and mirror polished pipes or pipes for the food industry according to DIN 11850/10357,.

Tube length: Cca. 6 m

Tolerances: ISO 1127

## DEBELINA V MM - THICKNESS IN MM

PREMER V MM Diameter in mm	1	1,25	1,5	1,65	2	2,5	2,6	3	3,2	3,6	4	5
6	0,125	0,148										
8	0,175	0,211	0,244									
10	0,225	0,273	0,319	0,344	0,400							
12	0,275	0,336	0,394	0,427	0,500							
14	0,326	0,399	0,470	0,510	0,600							
15	0,351	0,430	0,507	0,551	0,651							
16	0,376	0,462	0,545	0,593	0,701							
17,2	0,406	0,499	0,590	0,642	0,761							
18	0,426	0,524	0,620	0,676	0,801	0,970						
20	0,476	0,587	0,695	0,758	0,901	1,096	1,133	1,277				
21,3	0,508	0,628	0,744	0,812	0,967	1,177	1,217	1,375				
22	0,526	0,649	0,770	0,841	1,002							
25	0,601	0,743	0,883	0,965	1,152	1,409	1,458	1,653				
25,4	0,611	0,756	0,898	0,981	1,172	1,434	1,484	1,683				
26,9	0,649	0,803	0,954	1,043	1,247	1,527	1,582	1,795	1,899			
28	0,676	0,837	0,995	1,089	1,302							
30	0,726	0,900	1,070	1,171	1,402	1,722	1,784					
32	0,776	0,962	1,146	1,254	1,502	1,847	1,914	2,178				
33		0,944	1,183	1,295	1,552							
33,7	0,819	1,016	1,209	1,324	1,588	1,953	2,025	2,306	2,444	2,710	2,970	
34	0,826	1,025	1,221	1,337	1,603	1,972						
35	0,851	1,056	1,258	1,378	1,653	2,035						
38	0,926	1,150	1,371	1,502	1,803	2,222	2,305	2,629				
38,1	0,929	1,153	1,375	1,506	1,808	2,229	2,311	2,637				
40	0,977	1,213	1,446	1,584	1,903	2,348	2,435	2,779				
42,4	1,037	1,288	1,536	1,684	2,023	2,498	2,591	2,960	3,141	3,498	3,846	
44,5	1,089	1,354	1,615	1,770	2,128	2,629	2,728	3,117				
45	1,102	1,369	1,634	1,791	2,153	2,661						
48,3	1,184	1,473	1,758	1,927	2,319	2,867	2,975	3,403	3,614	4,029	4,437	
50	1,227	1,526	1,822	1,998	2,404	2,974	3,086	3,531	3,75	4,183	4,607	

PREMER V MM Diameter in mm	DEBELINA V MM - THICKNESS IN MM											
	1	1,25	1,5	1,65	2	2,5	2,6	3	3,2	3,6	4	5
50,8	1,247	1,551	1,852	2,031	2,444	3,024	3,138	3,591	3,814	4,255	4,687	
51	1,252	1,557	1,859	2,039	2,454	3,036	3,151	3,606	3,83	4,273	4,708	
52	1,277	1,588	1,897	2,08	2,504	3,099	3,21	3,68				
54	1,327	1,651	1,972	2,163	2,604	3,224	3,346	3,831	4,071			
57		1,677	2,085	2,287	2,754	3,412	3,542	4,056				
60,3		1,848	2,209	2,423	2,92	3,618	3,757	4,304	4,575	5,111	5,639	
63,5		1,948	2,329	2,555	3,08	3,819	3,965	4,545	4,832	5,4	5,96	
70		2,152	2,573	2,824	3,405	4,226	4,388	5,033	5,353	5,986	6,611	
76,1		2,343	2,802	3,076	3,711	4,607	4,785	5,491	5,841	6,535	7,222	
80		2,465	2,948	3,237	3,906	4,852	5,039	5,784	6,154	6,887	7,612	
84		2,59	3,099	3,402	4,107	5,102	5,299	6,085	6,474	7,248	8,013	
85		2,621	3,136	3,444	4,157	5,165	5,365	6,16	6,554	7,338	8,113	
88,9		2,743	3,283	3,605	4,352	5,409	5,618	6,453	6,867	7,689	8,504	
101,6			3,76	4,13	4,988	6,204	6,445	7,407	7,885	8,834	9,776	12,09
104			3,85	4,229	5,108	6,354	6,602	7,587	8,077	9,05	10,016	12,39
108			4	4,394	5,308	6,604	6,862	7,888	8,397	9,411	10,417	12,89
114,3			4,237	4,654	5,624	6,999	7,272	8,361	8,902	9,979	11,048	13,64
129			4,789	5,262	6,36	7,919	8,229	9,465	10,08	11,304	12,52	15,52
139,7			5,191	5,704	6,896	8,589	8,926	10,269	10,937	12,269	13,592	16,86
154			5,727	6,29	7,612	9,484	9,857	11,343	12,083	13,558	15,024	18,65
156					7,712	9,609	9,987	11,493	12,244	13,738	15,224	18,91
168,3					8,328	10,379	10,788	12,417	13,229	14,847	16,456	20,41
204					10,116	12,614	13,112	15,099	16,09	18,065	20,032	24,91
206					10,216	12,739	13,242	15,249	16,25	18,245	20,232	25,16
219,1					10,872	13,559	14,095	16,233	17,3	19,426	21,544	26,79
254					12,62	15,744	16,367	18,855	20,096	22,572	25,04	31,17
256					12,72	15,869	16,497	19,005	20,256	22,752	25,24	31,42
273					13,572	16,933	17,604	20,282	21,619	24,285	26,943	33,55
304					15,124	18,874	19,622	22,611	24,103	27,079	30,048	37,43
305					15,174	18,937	19,687	22,686	24,183	27,169	30,148	37,56
306					15,224	18,999	19,753	22,761	24,263	27,26	30,248	37,68
323,9					16,121	20,12	20,918	24,106	25,697	28,873	32,041	39,92
355,6					17,708	22,104	22,982	26,487	28,237	31,731	35,216	43,89
406,4								30,3	32,3	36,3	40,3	50,25
457,2								34,1	36,3	40,8	45,4	56,71
508								37,9	40,4	45,4	50,4	62,97