

Dolžina cevi: Cca. 4 - 7 m

DIN: 17456/17458

Certifikat: EN 10204/3.1

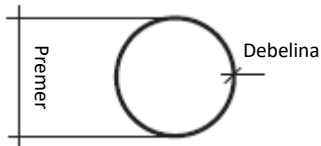

Tube length: Cca. 4 - 7 m

DIN: 17456/17458

Certificate: EN 10204/3.1

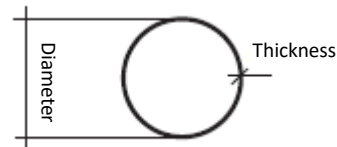

	Premer Diameter	Debelina Thicknes	KG/MT KG/MT	Cola Inch
	6	1	0,125	
	8	1	0,175	
	8	1,5	0,244	
	10	1	0,225	
	10	1,5	0,319	
	10,2	2	0,411	
	12	1	0,275	
	12	1,5	0,394	
	12	2	0,501	
10SCH	13,72	1,65	0,499	1/4"
40SCH	13,72	2,24	0,644	1/4"
80SCH	13,72	3,02	0,809	1/4"
	14	1	0,326	
	14	1,5	0,47	
	15	1	0,35	
	15	1,5	0,506	
	16	1	0,376	
	16	1,5	0,545	
10SCH	17,15	1,65	0,64	3/8"
40SCH	17,15	2,31	0,858	3/8"
80SCH	17,15	3,2	1,118	3/8"
	18	1	0,426	
	18	1,5	0,62	
	20	2	0,901	
	21,34	1,65	0,814	
10SCH	21,34	2,11	1,016	1/2"
40SCH	21,34	2,77	1,288	1/2"
80SCH	21,34	3,73	1,645	1/2"
	21,34	4,78	1,973	
	25	1,5	0,863	
	25	2	1,152	
	26,67	1,652	1,034	
10SCH	26,67	2,11	1,298	3/4"
40SCH	26,67	2,87	1,71	3/4"
80SCH	26,67	3,91	2,228	3/4"
	26,67	5,56	2,939	

	Premer Diameter	Debelina Thicknes	KG/MT KG/MT	Cola Inch
	30	2	1,402	
	30	2,5	1,722	
	33,4	1,65	1,312	
10SCH	33,4	2,77	2,125	1"
40SCH	33,4	3,38	2,541	1"
80SCH	33,4	4,55	3,287	1"
	33,4	6,35	4,301	1"
	42,16	1,65	1,674	1 1/4"
10SCH	42,16	2,77	2,732	1 1/4"
40SCH	42,16	3,56	3,441	1 1/4"
80SCH	42,16	4,85	4,531	1 1/4"
	42,16	6,35	5,694	
10SCH	48,26	2,77	3,155	1 1/2"
40SCH	48,26	3,68	4,108	1 1/2"
80SCH	48,26	5,08	5,493	1 1/2"
	48,26	7,14	7,352	
10SCH	60,33	2,77	3,992	2"
40SCH	60,33	3,91	5,524	2"
80SCH	60,33	5,54	7,601	2"
	60,33	8,74	11,29	
10SCH	73,03	3,05	5,345	2 1/2"
40SCH	73,03	5,16	8,769	2 1/2"
80SCH	73,03	7,01	11,589	2 1/2"
	76,1	2	3,711	
	76,1	2,9	5,315	
	76,1	3,65	6,622	
10SCH	88,9	3,05	6,557	3"
40SCH	88,9	5,49	11,466	3"
80SCH	88,9	7,62	15,509	3"
	88,9	11,13	21,674	
10SCH	101,6	3,05	7,526	3 1/2"
40SCH	101,6	5,74	13,778	3 1/2"
80SCH	101,6	8,08	18,921	3 1/2"
10SCH	114,3	3,05	8,496	4"
40SCH	114,3	6,02	16,322	4"
80SCH	114,3	8,56	22,665	4"