

### Objemka za verigo

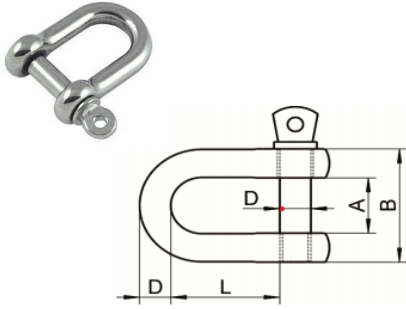

### D - shackles

D	A	L	B	DELOVNA OBREMENITEV	TOČKA PRELOMA
(mm)	(mm)	(mm)	(mm)	(kg)	(kg)
4	8	14	16	90	550
5	10	17	20	100	900
6	12	21	24	150	1300
8	16	28	32	250	2400
10	20	35	40	500	3800
12	24	42	48	600	5550

### Objemka za vrvi

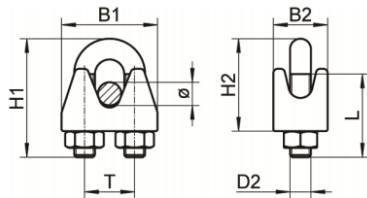

### Wire rope clips

VRV	H1	T	B1	B2	D2
(mm)	(mm)	(mm)	(mm)	(mm)	(mm)
2	17	7	16	10	M3
3	21	8	21	12	M3
4	23	10	22	12	M4
5	26	12	23	13	M5
6	32	14	26	13	M6
8	35	16	30	13	M6
10	44	19	34	22	M8

### Vodilo za vrvi

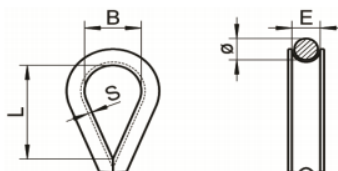

### Wire rope thimbles

VRV	B	L	E
(mm)	(mm)	(mm)	(mm)
2	7	10	2
3	10	17	3
4	11	18	4
5	13	20	5
6	15	25	6
8	18	33	8
10	23	41	10
12	27	48	12

**Napenjalec tip A**

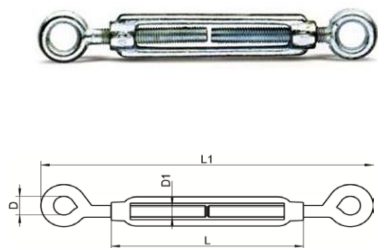

*Type A turnbuckles eye/eye*

D1	L	L1	D	DELOVNA OBREMENITEV	TOČKA PRELOMA
(mm)	(mm)	(mm)	(mm)	(kg)	(kg)
5	70	113	8	40	560
6	90	145	10	80	1100
8	120	187	14	140	2000
10	150	233	16	220	3000
12	200	299	18	300	4200

**Napenjalec tip B**

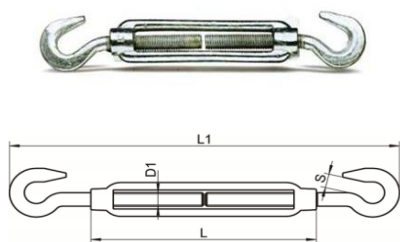

*Type B turnbuckles hook/hook*

D1	L	L1	S	DELOVNA OBREMENITEV	TOČKA PRELOMA
(mm)	(mm)	(mm)	(mm)	(kg)	(kg)
5	70	113	8	40	560
6	90	145	9	80	1100
8	120	187	11	140	2000
10	150	233	12	220	3000
12	200	299	14	300	4200

**Napenjalec tip C**

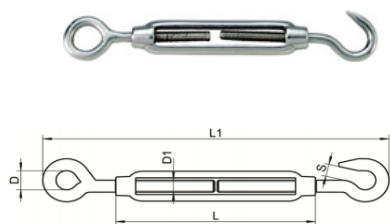

*Type C turnbuckles eye/hook*

D1	L	L1	D	S	DELOVNA OBREMENITEV	TOČKA PRELOMA
(mm)	(mm)	(mm)	(mm)	(mm)	(kg)	(kg)
5	70	113	8	8	40	560
6	90	145	10	9	80	1100
8	120	187	14	11	140	2000
10	150	233	16	12	220	3000
12	200	299	18	14	300	4200